

W6-W8

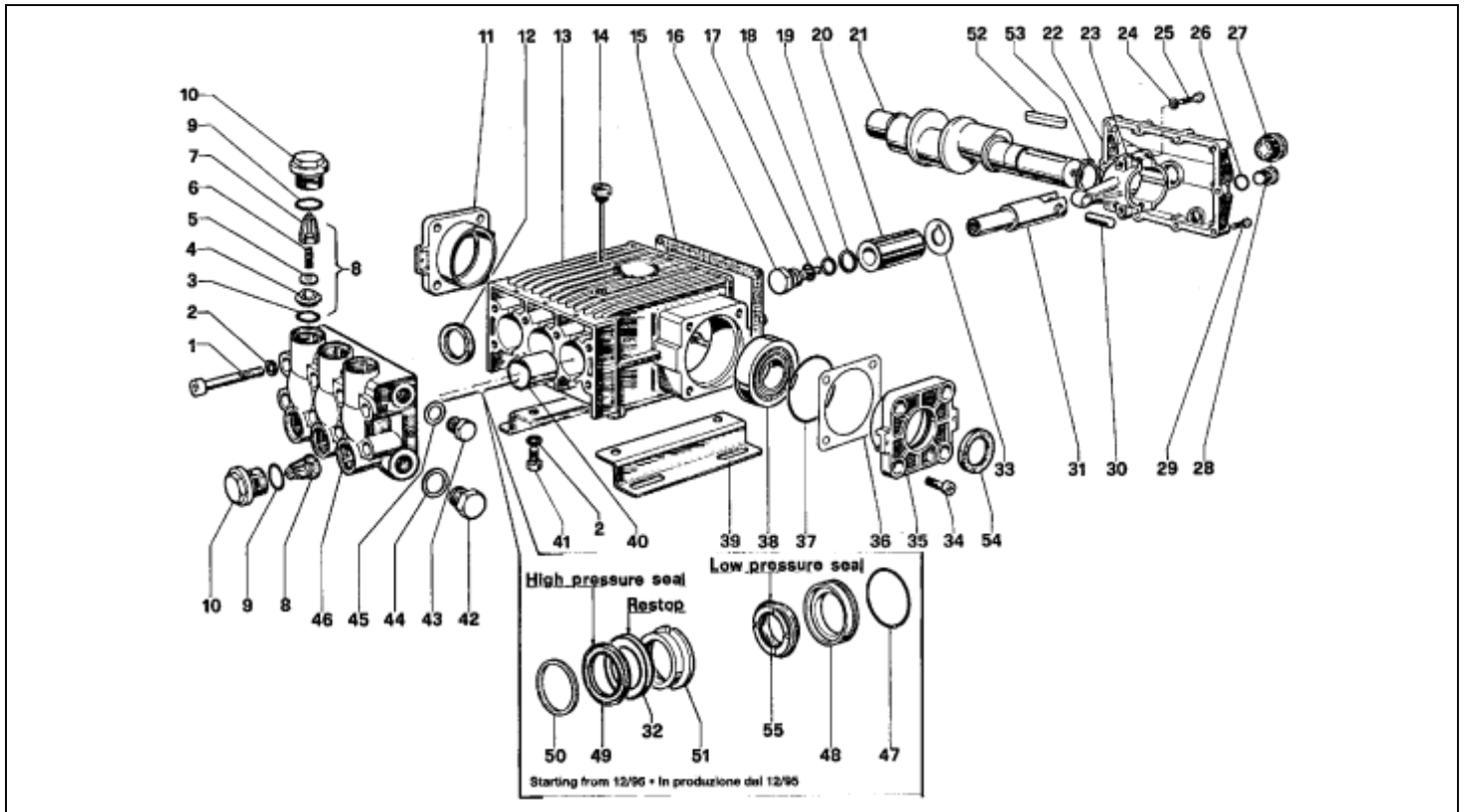

POS	REF	DESCRIPTION	KIT NO	QTY
1	99.4418.00	SCREW M12 X 90 UNI 5931		8
2	96.7195.00	WASHER DIA 12		12
3	90.4059.00	O-RING 32.93 X 3.53 -SPEC	KIT 43	6
4	36.2011.66	VALVE SEAT	KIT 43	6
5	36.2010.76	VALVE	KIT 43	6
6	94.7450.00	SPRING DIA 16.7 X 27.5	KIT 43	6
7	36.2009.51	VALVE GUIDE	KIT 43	6
8	36.7065.01	VALVE UNIT	KIT 43	6
9	90.4065.00	O-RING DIA 37.69 X 3.53		6
10	98.2420.00	CAP M42 X 1.5 X 23		6
11	76.1501.22	CRANKCASE COVER		1
12	90.1670.00	OIL SEAL DIA 35 X 52 X 7	KIT 44	3
13	76.0100.22	CRANKCASE		1
14	98.2270.00	OIL DIPSTICK		1
15	76.2119.84	GASKET COVER		1
16	69.2195.66	PISTON SCREW	KIT 74	3
17	90.3841.00	O-RING DIA 17.13 X 2.62	KIT 74	3
18	90.5107.00	ANTI-EXTRUSION RING	KIT 74	3
19	96.7555.00	WASHER DIA 22 X 27 X 0.5	KIT 74	3
20	69.0402.09	PISTON DIA 45		3
21	76.0211.35	CRANKSHAFT P. DI F. W6		1
22	76.1600.22	CRANKCASE COVER		1
23	76.0303.01	CONNECTING ROD		3
24	96.7014.00	WASHER DIA 10.5		6
25	99.3720.00	SCREW M10 X 45 UNI 5931		6
26	90.3833.00	O-RING DIA 13.95 X 2.62		2
27	97.5968.00	OIL SIGHT GLASS G ¾		1
28	98.2100.00	CAP G 3/8 X 13		2

POS	REF	DESCRIPTION	KIT NO	QTY
29	99.1897.00	SCREW M6 X 25 UNI 5931		10
30	97.7400.00	PISTON PIN DIA 14 X 34.5		3
31	77.0500.54	PISTON GUIDE		3
32	90.2848.00	RESTOP DIA 45	KIT 79-80-81	3
33	96.7568.00	WASHER DIA 22.3 X 51 X 0.5		3
34	99.3652.00	SCREW M10 X 20 UNI 5931		8
35	76.1500.22	CRANKCASE COVER		1
36	76.2200.78	SHIM		2
37	90.4141.00	O-RING DIA 85.32 X 3.53		2
38	91.8474.00	BALL BEARING		2
39	76.2000.74	FOOT		2
40	90.9174.00	CYLINDER GUIDE DIA 35 X 39 X 50		3
41	99.4266.00	SCREW M12 X 25 UNI 5739		4
42	98.2325.00	CAP G 1 X 17		1
43	98.2265.00	CAP G ¾ X 16		1
44	96.7870.00	WASHER DIA 33.5 X 38 X 1.5		1
45	96.7700.00	WASHER DIA 26.5 X 32 X 1.5		1
46	76.1200.41	MANIFOLD PUMP OT 58 - BRASS		1
47	90.3903.00	O-RING DIA 60 X 2.62	KIT 47-80	3
48	76.0802.70	PACKING RETAINER DIA 45	KIT 47-80	3
49	90.2580.00	PACKING DIA 45 HP SEAL	KIT 79-80	3
50	76.1002.51	HEAD RING DIA 45	KIT 48-80	3
51	76.2170.70	INTERMEDIATE RING DIA 45	KIT 80-81	3
52	91.4978.00	KEY		1
53	90.0695.00	CIRCLIP		1
54	90.1672.00	OIL SEAL DIA 35 X 25 X 8	KIT 32	1
55	90.2855.00	PACKING DIA 45 LP SEAL	KIT 79-80	3

SERVICE REPAIR KITS AVAILABLE:

KIT NO	KIT 32	KIT 43	KIT 44	KIT 47	KIT 48	KIT 74	KIT 79	KIT 80	KIT 1
POSITIONS INCLUDED	54	3-4-5-6-7-(8)	12	47-48	50	16-17-18-19	32-49-55	32-47-48-49-50-11-55	32-51
N. PCS	2	6	3	3	6	3	3	1	3