

T77B-T88B

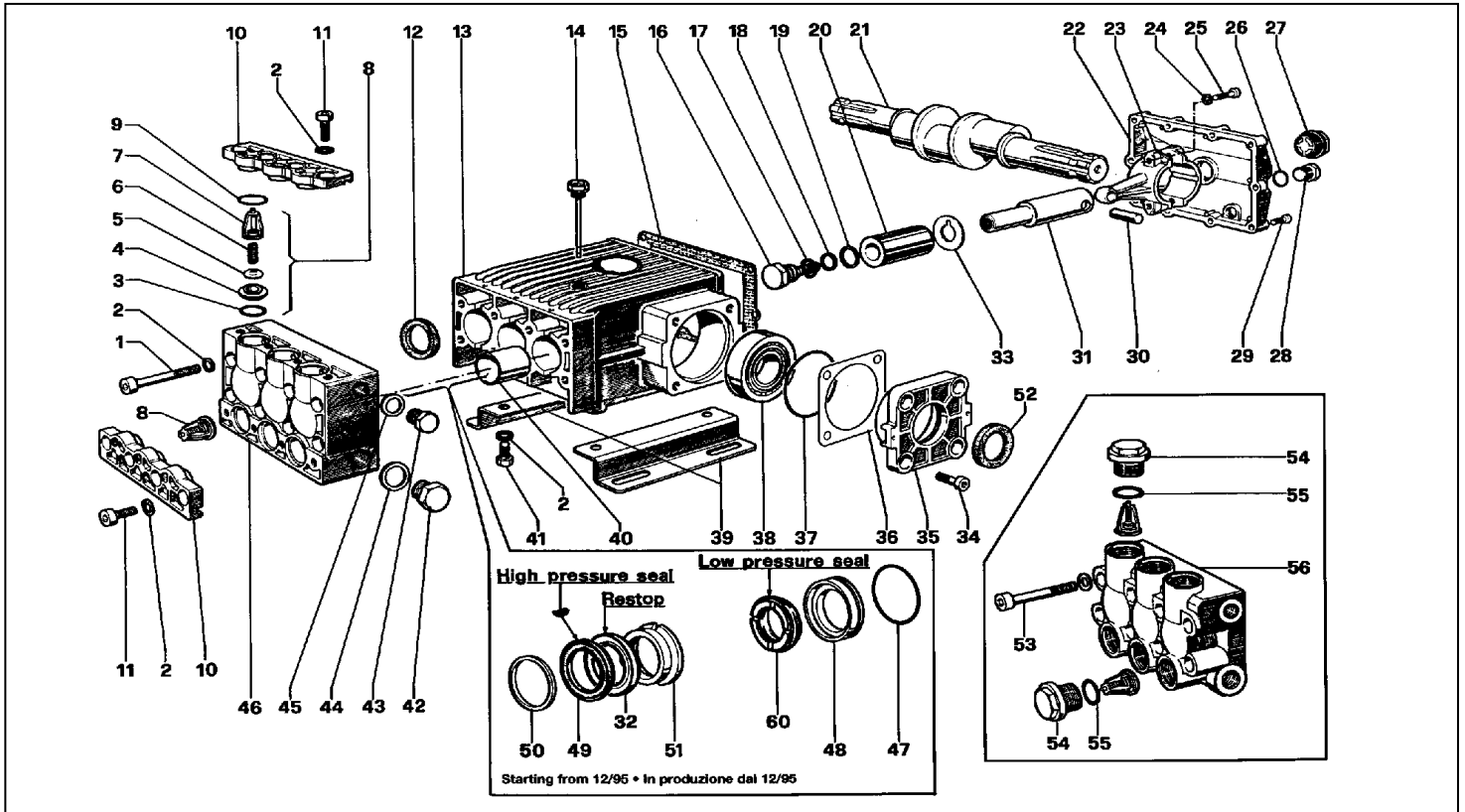

POS	REF	DESCRIPTION	KIT NO	QTY
1	99.4400.00	SCREW M21X80 UNI 5931		8
2	96.7195.00	WASHER DIA 12		20
3	90.4097.00	O-RING 32X93X3,53	KIT 43	6
4	36.2011.66	VALVE SEAT	KIT 43	6
5	36.2010.76	VALVE	KIT 43	6
6	94.7450.00	SPRING DIA 16X27	KIT 43	6
7	36.2009.51	VALVE GUIDE	KIT 43	6
8	36.7065.01	VALVE UNIT	KIT 43	6
9	90.4067.00	O-RING DIA 39,69X3,53		6
10	76.2180.22	VALVE COVER		2
11	99.4280.00	SCREW M12X30 UNI 5931		8
12	90.1670.00	OIL SEAL DIA 35X52X7	KIT 44	3
13	76.0100.22	CRANCASE		1
14	98.2270.00	OIL DIPSTICK		1
15	76.2119.84	GASKER COVER		1
16	69.2195.66	PISTON SCREW		1
17	90.3841.00	O-RING DIA 17,13X2,62	KIT 74	3
18	90.5107.00	ANTI-EXTRUSION RING	KIT 74	3
19	96.7555.00	WASHER DIA 22X27X0,5	KIT 74	3
20	76.0402.09	PISTON DIA 45	KIT 74	3
21	76.0201.35	CRANKSHAFT 1"3/8 - 1"3/8		1
22	76.1600.22	CRANKCASE COVER		1
23	76.0300.01	CONNECTING ROD		3
24	96.7104.00	WASHER DIA 10,5		6
25	99.3720.00	SCREW M10X45 UNI 5931		6
26	90.3833.00	O-RING DIA 13,95X2,62		2
27	97.5968.00	OIL SIGHT GLASS		1
28	98.2100.00	CAP G 3/8X13		1
29	99.1897.00	SCREW M6X25 UNI 5931		10
30	97.7400.00	PISTON PIN DIA 14X34,5		3

POS	REF	DESCRIPTION	KIT NO	QTY
31	77.0500.22	PISTON GUIDE		3
32	90.2848.00	RESTOP DIA 45	KIT 79-80-81	3
33	96.7568.00	WASHER DIA 22,3X51X0,5		3
34	99.3652.00	SCREW M10X20 UNI 5931		8
35	76.1500.22	CRANKCASE COVER		2
36	76.2200.78	SHIM		2
37	90.4141.00	O-RING DIA 85,32X3,53		2
38	91.8473.00	BALL BEARING		2
39	76.2000.74	FOOT		2
40	90.9174.00	BUSH DIA 35X39X50		3
41	99.4266.00	SCREW M12X25 UNI 5739		4
42	98.2325.00	CAP G 1X17		1
43	98.2265.00	CAP G 3/4X16		1
44	96.7870.00	WASHER DIA 33,5X38X1,5		1
45	96.7700.00	WASHER DIA 26,5X32X1,5		1
46	76.1200.22	CYLINDER HEAD NOT BRASS		1
47	90.3903.00	O-RING DIA 60X2,62	KIT 47-80	3
48	76.0802.70	PACKING RETAINER DIA 45	KIT 47-80	3
49	90.2850.00	OIL SEAL DIA 45 H.P SEAL	KIT 79-80	3
50	76.1002.51	HEAD RING DIA 45	KIT 48-80	3
51	76.2170.70	INTERMEDIATE RING DIA 45	KIT 80-81	3
52	90.1672.00	OIL SEAL DIA 35X52X8	KIT 32	2
60	90.2855.00	PACKING DIA 45 L.P SEAL	KIT 79-80	3
		BRASS MANIFOLD VERSION		
53	99.4418.00	SCREW M12X90 UNI 5931		8
54	98.2420.00	CAP M42X1,5X23		6
55	90.4065.00	O-RING DIA 37,69X3,53		6
56	76.1200.41	MANIFOLD BRASS		1

SERVICE REPAIR KITS AVAILABLE:

KIT NO	KIT 32	KIT 43	KIT 44	KIT 47	KIT 48	KIT 74	KIT 79	KIT 80	KIT 81
POSITIONS INCLUDED	52	3-4-5-6-7 (8)	12	47-48	50	16-17 18-19	32-49-60	32-47-48 49-50-51 60	32-51
N. PCS	2	6	3	3	6	3	3	1	3